



Shetland Court, Bressay Drive

£385,000

Cosway Estates are pleased to offer for sale this exceptionally well presented two double bedroom, two bathroom purpose built ground floor flat with direct access to outdoor space. situated on the popular Grosvenor Park development, approximately one mile from both Mill Hill Broadway Thameslink Station and Mill Hill East tube station.

The property is presented in excellent decorative order and comprises a bright and spacious lounge/dining room semi open plan to fully fitted kitchen with integrated appliances, two double bedrooms one with en-suite shower room and tiled modern family bathroom. Well kept Communal gardens available too.

Underground allocated parking space. Chain free.

Lease Remaining 134 Years, Service Charge £1030pa ,Ground Rent £236pa.

Viewing

Please contact our Mill Hill Office on 020 8959 0011 if you wish to arrange a viewing appointment for this property or require further information.



Floor Plan

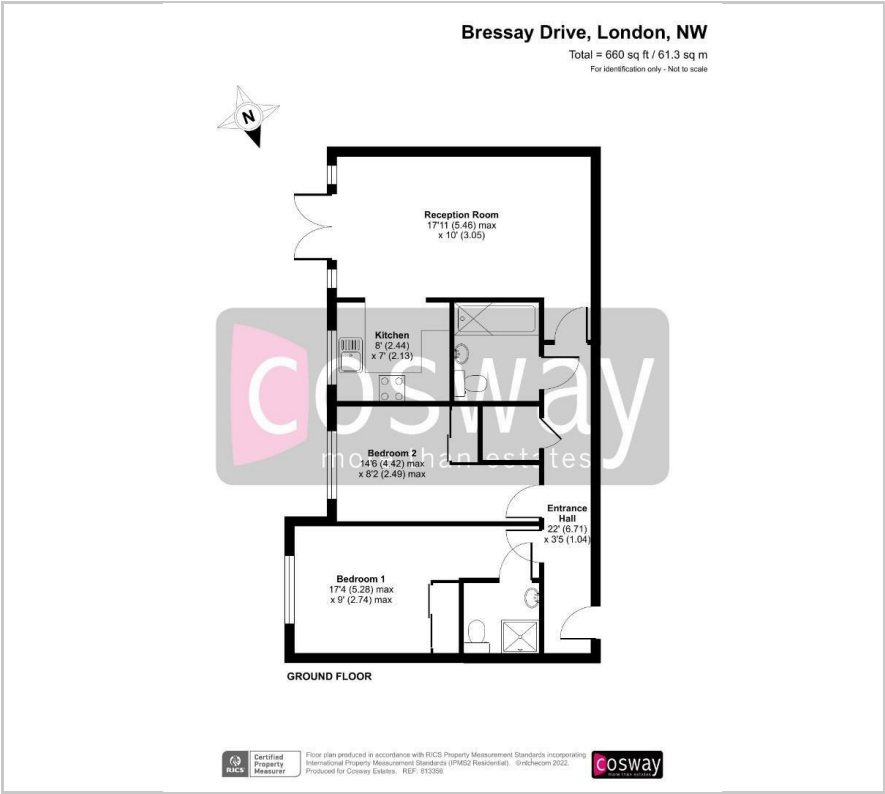

Area Map



Energy Efficiency Graph

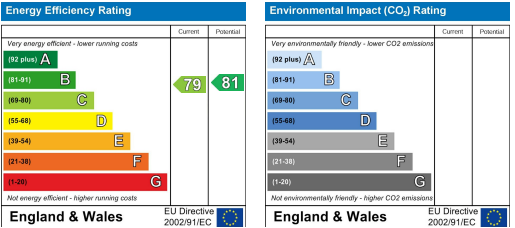

These particulars, whilst believed to be accurate are set out as a general outline only for guidance and do not constitute any part of an offer or contract. Intending purchasers should not rely on them as statements of representation of fact, but must satisfy themselves by inspection or otherwise as to their accuracy. No person in this firm's employment has the authority to make or give any representation or warranty in respect of the property.